



# **WING PULLEYS**

***Wing Pulleys are used primarily on light and medium duty conveyor systems.***

- Breaking surface contact with the belt creates vibration cleaning off sticking material.
- Deflectors discharge material to the sides of the conveyor.
- Reinforcing ring on 16" diameter and above.



***High Abrasion Contact Bars & Spiral Wrap available for heavy duty applications***

- Luff's Spiral Wing Pulley design ensures the spiral wrap is in constant contact with the belt which eliminates noise and vibration while offering a cleaning action.
- Helically wrapped from center discharging material.
- Spiral pulleys can operate over 450 fpm.
- Standard 3/16" x 1" or 3/8" x 1" spiral wrap

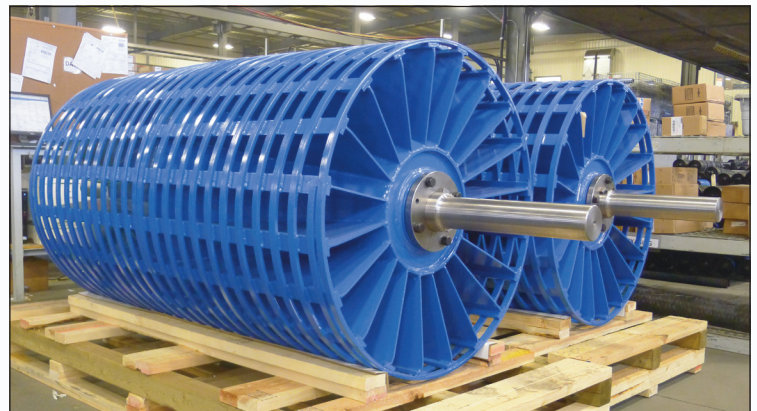

***Standard Duty, Mine Duty and Engineered Class available***

***2 Year Warranty***

***5 Day Delivery***

*\* for non-stock products*

- Luff's Helix design offers stronger pulley construction while maintaining constant belt contact, resulting in reduced vibration, less wear on the conveyor belt and quieter operation.

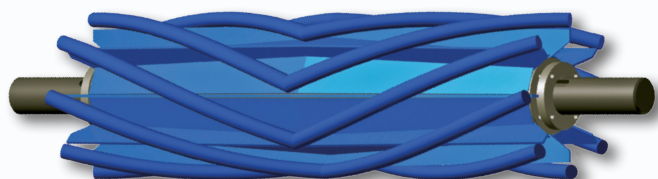

**Luff Industries Ltd.**  
235010 Wrangler Road  
Rocky View, (Calgary) Alberta, T1X 0K3

TF: 1.888.349.LUFF (5833)

P: 403.279.3555

F: 403.279.5709

***Conveying Performance***

[info@luffindustries.com](mailto:info@luffindustries.com)  
[www.luffindustries.com](http://www.luffindustries.com)

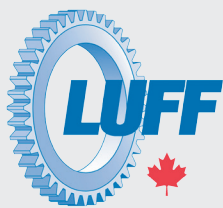

# WING PULLEYS

## LAGGING

- A blend of natural and SBR chemically molded to a 12-gauge formed steel channel.
- Engineered for maximum traction in both directions, allowing Luff Wing Lagging to be utilized on reversing belts also.

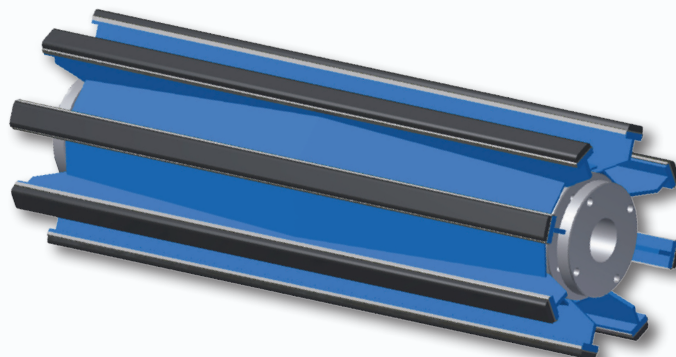

## WING PULLEY LAGGING - NUMBER OF 32" STRIPS REQUIRED FOR SELECTING FACE WIDTHS AND DIAMETERS

| No. Of Fins | Flat Bar Size | Dia. | Number of Strips for Selected Face & Diameter |    |    |    |    |    |    |    |    |    |    |    |    |    |
|-------------|---------------|------|---|----|----|----|----|----|----|----|----|----|----|----|----|----|
|             |               |      | 12  | 14 | 16 | 18 | 20 | 22 | 26 | 32 | 38 | 44 | 51 | 57 | 63 | 72 |
| 8           | 1.5"          | 6    | 4   | 4  | 4  | 5  | 5  | 6  | 7  | 8  | 10 | 11 | 14 | 16 | 16 | 18 |
| 8           | 1.5"          | 8    | 4   | 4  | 4  | 5  | 5  | 6  | 7  | 8  | 10 | 11 | 14 | 16 | 16 | 18 |
| 8           | 1.5"          | 10   | 4   | 4  | 4  | 5  | 5  | 6  | 7  | 8  | 10 | 11 | 14 | 16 | 16 | 18 |
| 8           | 1.5"          | 12   | 4   | 4  | 4  | 5  | 5  | 6  | 7  | 8  | 10 | 11 | 14 | 16 | 16 | 18 |
| 10          | 1.5"*         | 14   | 4   | 5  | 5  | 6  | 7  | 8  | 9  | 10 | 12 | 14 | 16 | 20 | 20 | 23 |
| 10          | 1.5"*         | 16   | 4   | 5  | 5  | 6  | 7  | 8  | 9  | 10 | 12 | 14 | 16 | 20 | 20 | 23 |
| 12          | 1.5"          | 18   | 5   | 6  | 6  | 7  | 8  | 8  | 11 | 12 | 15 | 17 | 20 | 23 | 24 | 27 |
| 12          | 2"            | 20   | 5   | 6  | 6  | 7  | 8  | 8  | 11 | 12 | 15 | 17 | 20 | 23 | 24 | 27 |
| 14          | 2"            | 24   | 6   | 7  | 7  | 8  | 10 | 10 | 12 | 14 | 17 | 20 | 24 | 28 | 28 | 32 |
| 18          | 2"            | 30   | 7   | 8  | 9  | 11 | 12 | 13 | 15 | 18 | 22 | 25 | 28 | 34 | 34 | 38 |
| 18          | 2"            | 36   | 7   | 8  | 9  | 11 | 12 | 13 | 15 | 18 | 22 | 25 | 28 | 34 | 34 | 38 |
| 20          | 2"            | 42   | 8   | 9  | 10 | 12 | 13 | 14 | 17 | 20 | 24 | 27 | 32 | 36 | 38 | 43 |
| 22          | 2"            | 48   | 9   | 10 | 11 | 13 | 15 | 15 | 18 | 22 | 26 | 30 | 34 | 42 | 42 | 47 |

\* Mine Duty Wing Pulleys use FB size 2"

- Reduces belt and pulley wear
- Can be used on reverse belt conveyors
- Decreases downtime as the lagging can be replaced without removing the pulley
- Reduce maintenance costs
- Helps prevent belt slippage
- Fits flat and crowned face pulley



**Luff Industries Ltd.**  
235010 Wrangler Road  
Rocky View, (Calgary) Alberta, T1X 0K3

TF: 1.888.349.LUFF (5833)  
P: 403.279.3555  
F: 403.279.5709

## Replaceable Lagged Contact Bars Available

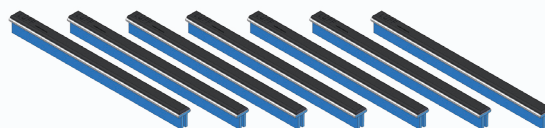

**Conveying Performance**

info@luffindustries.com  
www.luffindustries.com