

WING PULLEY LAGGING

LAGGING

- A blend of natural and SBR chemically molded to a 12-gauge formed steel channel.
- Engineered for maximum traction in both directions, allowing Luff Wing Lagging to be utilized on reversing belts also.

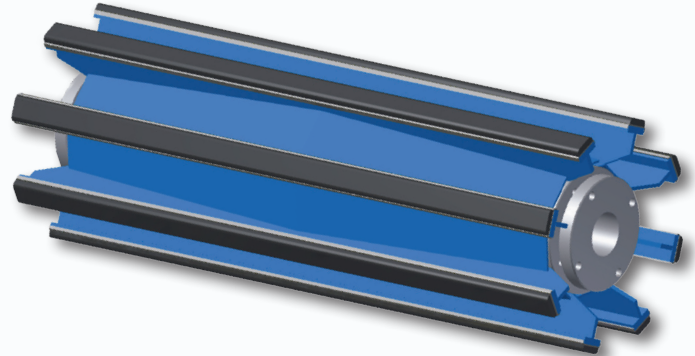

WING PULLEY LAGGING - NUMBER OF 32" STRIPS REQUIRED FOR SELECTING FACE WIDTHS AND DIAMETERS

No. Of Fins	Flat Bar Size	Dia.	Number of Strips for Selected Face & Diameter													
			12	14	16	18	20	22	26	32	38	44	51	57	63	72
8	1.5"	6	4	4	4	5	5	6	7	8	10	11	14	16	16	18
8	1.5"	8	4	4	4	5	5	6	7	8	10	11	14	16	16	18
8	1.5"	10	4	4	4	5	5	6	7	8	10	11	14	16	16	18
8	1.5"	12	4	4	4	5	5	6	7	8	10	11	14	16	16	18
10	1.5"*	14	4	5	5	6	7	8	9	10	12	14	16	20	20	23
10	1.5"*	16	4	5	5	6	7	8	9	10	12	14	16	20	20	23
12	1.5"	18	5	6	6	7	8	8	11	12	15	17	20	23	24	27
12	2"	20	5	6	6	7	8	8	11	12	15	17	20	23	24	27
14	2"	24	6	7	7	8	10	10	12	14	17	20	24	28	28	32
18	2"	30	7	8	9	11	12	13	15	18	22	25	28	34	34	38
18	2"	36	7	8	9	11	12	13	15	18	22	25	28	34	34	38
20	2"	42	8	9	10	12	13	14	17	20	24	27	32	36	38	43
22	2"	48	9	10	11	13	15	15	18	22	26	30	34	42	42	47

* Mine Duty Wing Pulleys use FB size 2"

- Reduces belt and pulley wear
- Can be used on reverse belt conveyors
- Decreases downtime as the lagging can be replaced without removing the pulley
- Reduce maintenance costs
- Helps prevent belt slippage
- Fits flat and crowned face pulley

Replaceable Lagged Contact Bars Available

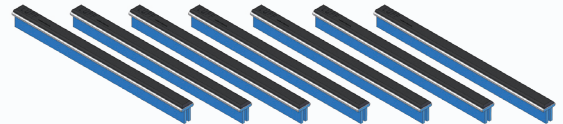

Luff Industries Ltd.
235010 Wrangler Road
Rocky View, (Calgary) Alberta, T1X 0K3

TF: 1.888.349.LUFF (5833)
P: 403.279.3555
F: 403.279.5709

Conveying Performance

info@luffindustries.com
www.luffindustries.com