

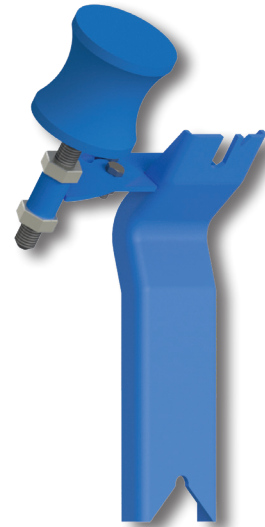

Adjustable Guide Roller Bracket



Precision-Tuned Control: Dual-axis adjustment allows for exact positioning, enabling aggressive and responsive belt tracking corrections.

Enhanced Belt Stability: Maintains optimal belt alignment, minimizing spillage, reducing wear, and extending component life.

Optimized for Variable Conditions: Designed to accommodate shifts in belt travel and changing load demands, ensuring consistent alignment in dynamic environments.

Versatile Configuration: Easily adapts to a wide range of conveyor systems, making it ideal for both new installations and retrofit applications.



Conveying Performance