

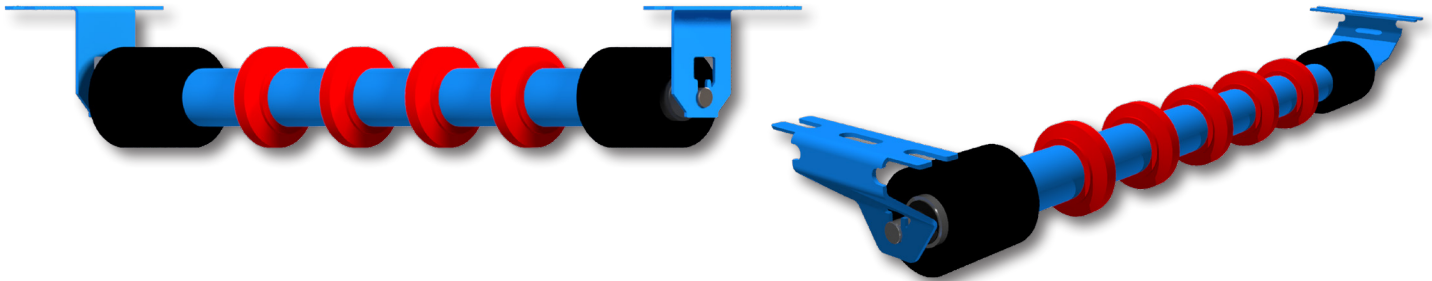

Urethane Disc Return Rollers



Cut Downtime, Boost Productivity: Luff's innovative design delivers up to 5x the lifespan of standard rubber disc return rolls, keeping your operation running longer, with fewer interruptions.

Self-Cleaning Efficiency That Protects Your Belt: Engineered to shed excess debris, our return rolls prevent material build-up and reduce belt wear, minimizing maintenance and extending belt life.

Built Tough Where It Matters Most: Polyurethane center discs target high-wear zones with extreme abrasion resistance, perfect for demanding material handling applications.

Dependable Performance in Extreme Conditions: Designed to operate in temperatures up to 100°C, Luff rolls thrive in high-heat, heavy-duty environments where others fail.

Precision Fit for Any Setup: Available in standard belt widths from 18" to 96", our rolls are built to integrate seamlessly into your existing system.



Live Shaft: Luff's Live Shaft design provides customers with a larger shaft and pillow block bearings which reduces shaft deflection and can accept heavier loads.

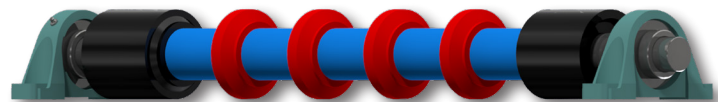

Conveying Performance